

PANTHER STADIUM



FUNDING SECURED

\$10,000 Donors

- Leeward Energy
- Randy & Kim Beers
- S.P. McCarl & Co
- Knopp and Klatt
Excavation & Concrete

\$500,000 Donor Anonymous

\$100,000 Donors

- Paul & Maureen
Calandra
- Rosebud Mining
- Bob Biter Electric

The Community Will Invest In Our Students!

Additional Funding

T-Mobile Award -\$5,000

Penn Cambria School District – Proposed Stadium Revitalization Initiative



21 February 2025

Penn Cambria School District – Proposed Stadium Revitalization Initiative

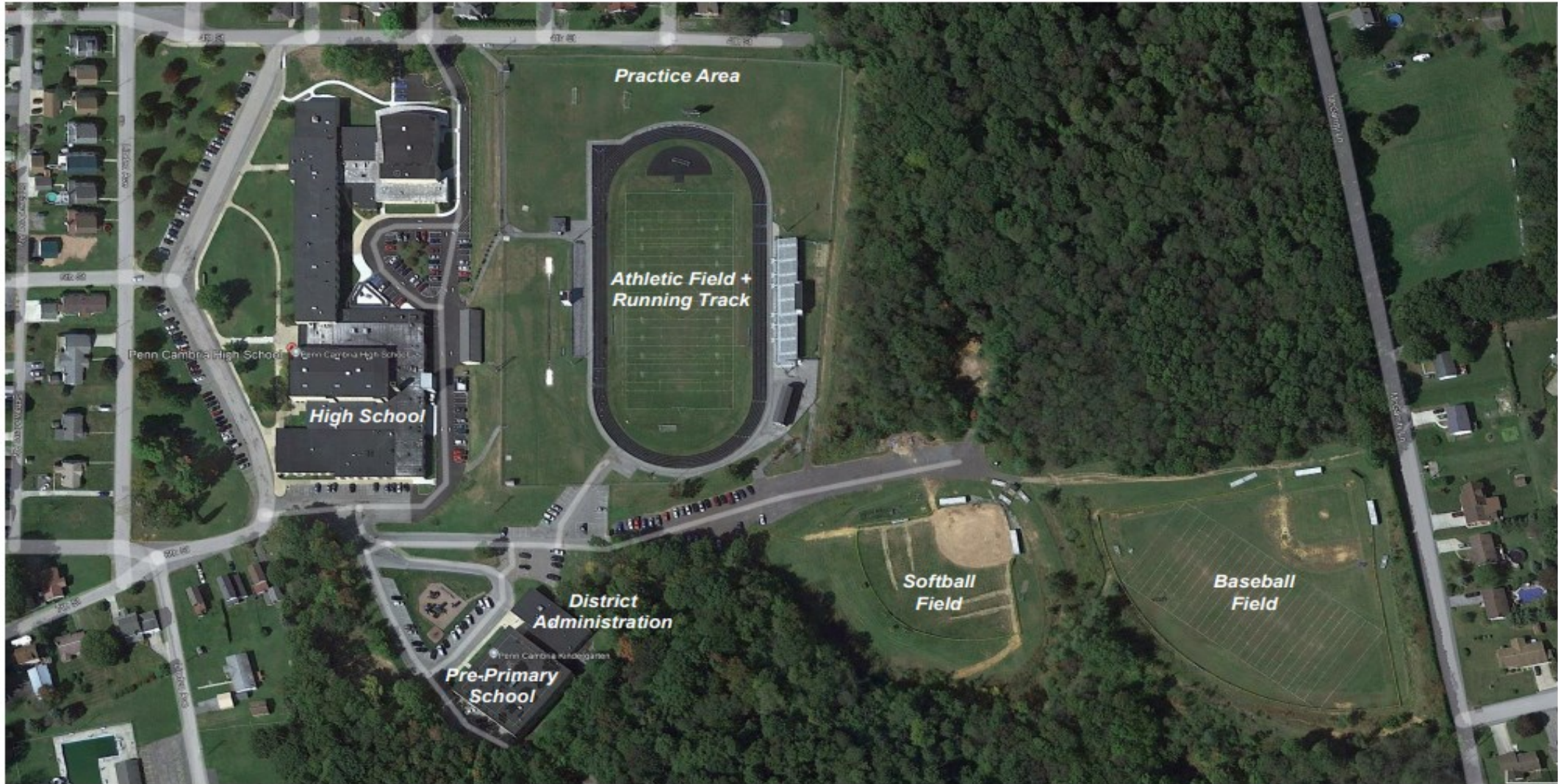

Penn Cambria High School Campus - Current Satellite Image

Penn Cambria School District – Proposed Stadium Revitalization Initiative



Penn Cambria High School Stadium - Current Satellite Image

Penn Cambria School District – Proposed Stadium Revitalization Initiative



Penn Cambria High School Campus – Proposed Master Plan



Penn Cambria High School Stadium – Proposed Improvements



New Artificial Turf Proposed Field Graphics

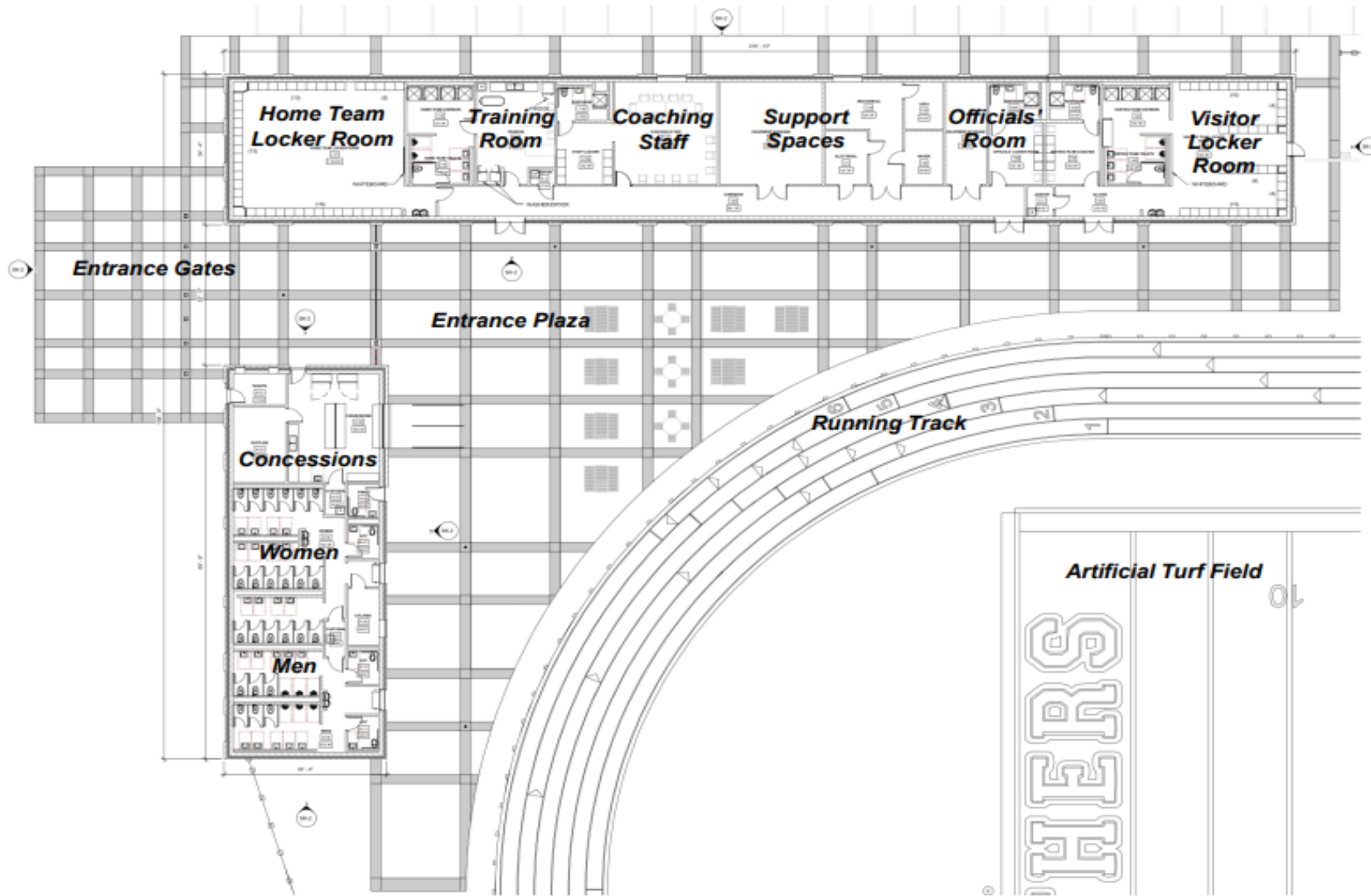

Proposed Fieldhouse + Amenities Building Floor Plans



Entrance Gates and Ticket Booth view looking toward New Stadium



Fieldhouse view from New Parking Area

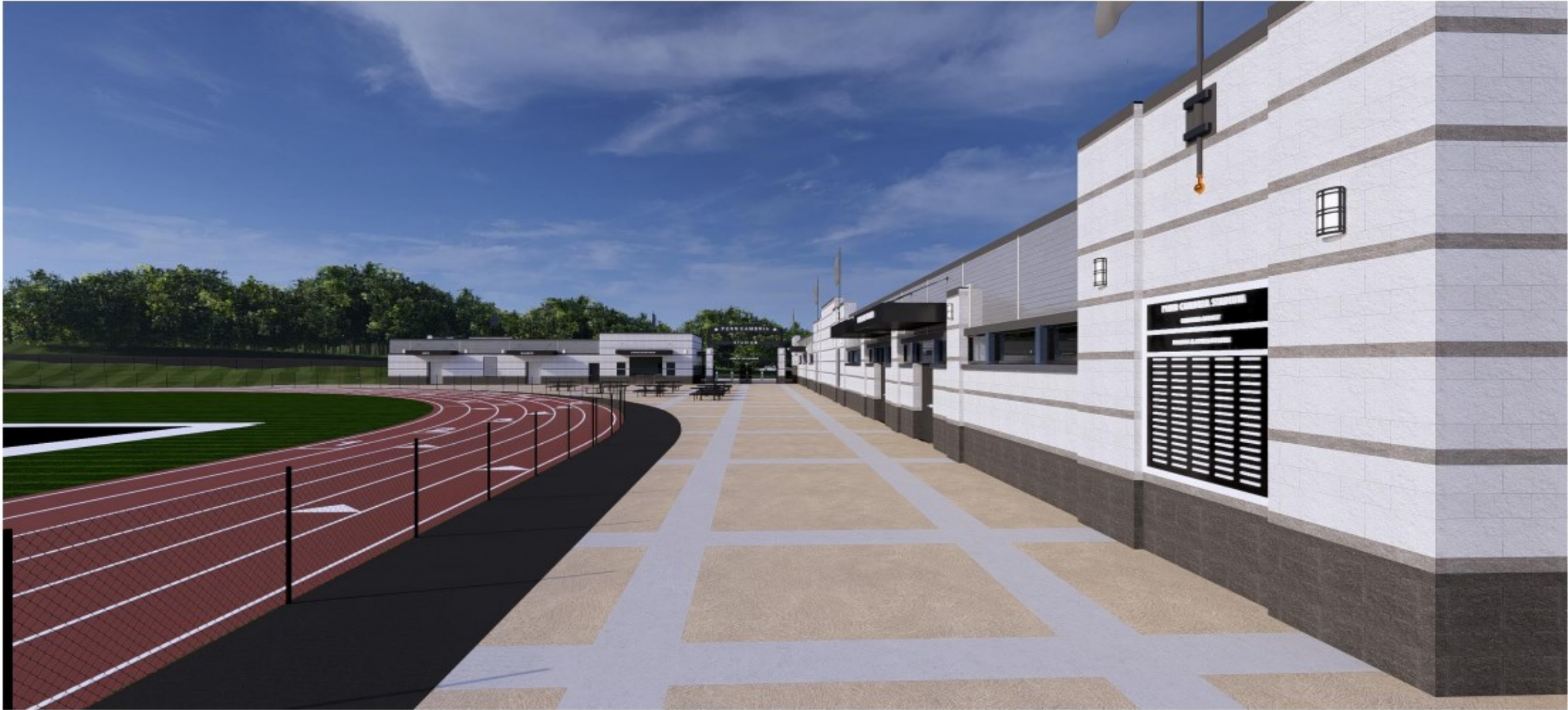

View along Fieldhouse looking toward Entrance Gates and Amenities Building



Amenities Building and Fieldhouse view from Plaza



Field and Plaza view from inside Entrance Gates



Field View From Home Side Bleachers

PHASED APPROACH



Phase 1

- ▶ **Parking improvements**
- ▶ **Demolish old concession stand and ticket booth**
- ▶ **Stormwater management**
- ▶ ***All work Included in project**

Phase 2

- ▶ **Replacement of field playing surface**
- ▶ **Replacement of track and event areas**
- ▶ **Replacement of 4' fencing around track**
- ▶ **Overlay of paved apron around track**
- ▶ **Replacement of visitor bleachers**
- ▶ **Lighting improvements to LED**
- ▶ **Improvements to old press box**

PHASED APPROACH



Phase 3

- ▶ **New concessions**
- ▶ **New restrooms**
- ▶ **New ticketing**

Phase 4

- ▶ **Fieldhouse**
- ▶ **Locker rooms**
- ▶ **Training room**
- ▶ **Support spaces**
- ▶ **New entrance gateway and concrete plaza**

Stadium Physical Challenges



- Asphalt around concessions
- Exterior and interior fencing lifting out of ground
- Visitor bleachers (handrails and walkways)
- Athletic field playing surface (non-contact injuries)
- Track surface

Student Missed Opportunities



- No home track meets
- Unable to host PIAA playoff games (soccer and football)
- Mainline Panther youth day
- Practice space

Facility Uses



- Practice Space
- Physical Education Classes
- Kindergarten Graduation
- Mainline Youth Programs
- Community Members

PANTHER STADIUM



FUNDING SECURED

\$10,000 Donors

- Leeward Energy
- Randy & Kim Beers
- S.P. McCarl & Co
- Knopp and Klatt
Excavation & Concrete

\$500,000 Donor Anonymous

\$100,000 Donors

- Paul & Maureen
Calandra
- Rosebud Mining
- Bob Biter Electric

The Community Will Invest In Our Students!

Additional Funding

T-Mobile Award -\$5,000